

**GENERAL NOTES**

1. DELIVERY IS MADE BY CRANE-EQUIPPED TRUCKS
2. MIN OVERHEAD CLEARANCE OF 18FT IS REQUIRED
3. ALL UNITS MUST BE HANDLED WITH PROPER LIFTING EQUIPMENT (I.E. SPREADER BAR)
4. DESIGNED FOR A MAXIMUM FILL DEPTH OF 1000mm, NO MINIMUM FILL DEPTH AND 12kPa VEHICLE LOADING.

2 1/2" LIFTING ANCHOR  
4 REQUIRED (TYP.)

TOP VIEW  
SCALE: 1/16

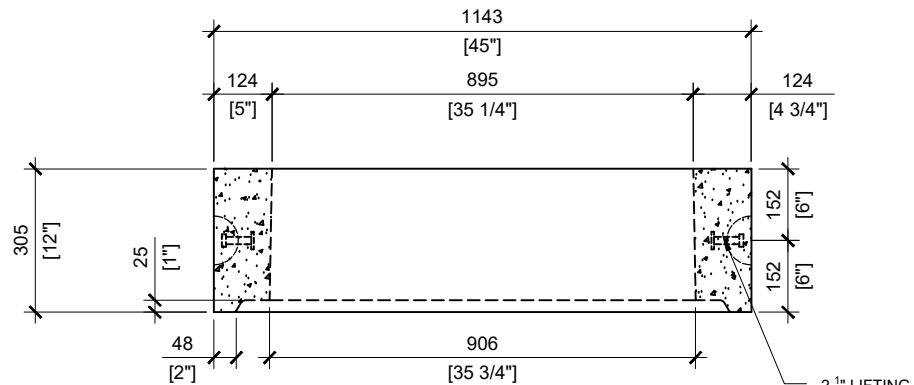

2 1/2" LIFTING ANCHOR  
4 REQUIRED (TYP.)

12" RISER FRONT VIEW  
SCALE: 1/16



MANUFACTURED:  
LINDSAY, ON  
1-800-655-3430

CONCRETE: 35MPa at 28 days/5000PSI    WEIGHT OF 12" RISER: 746lbs/338kg  
AIR ENTRAINMENT: 5-8%  
REINFORCEMENT: STEEL TO CSA CAN  
A23.1 /A23.3 G30.18 Fy=400MPa

DRAWN BY:  
PRASHAN

DATE:  
JUL/2024

36"X36" CONCRETE RISER 12" HIGH FLAT TOP

12" RISER - 35 3/4" X 35 3/4" INTERNAL OPENING